

# CoE-IHS Office Hour: Integrated Care Strategies to Improve Perinatal Health Equity

Thursday, August 25th, 2022  
3-4pm ET

# Questions, Comments & Closed Captioning

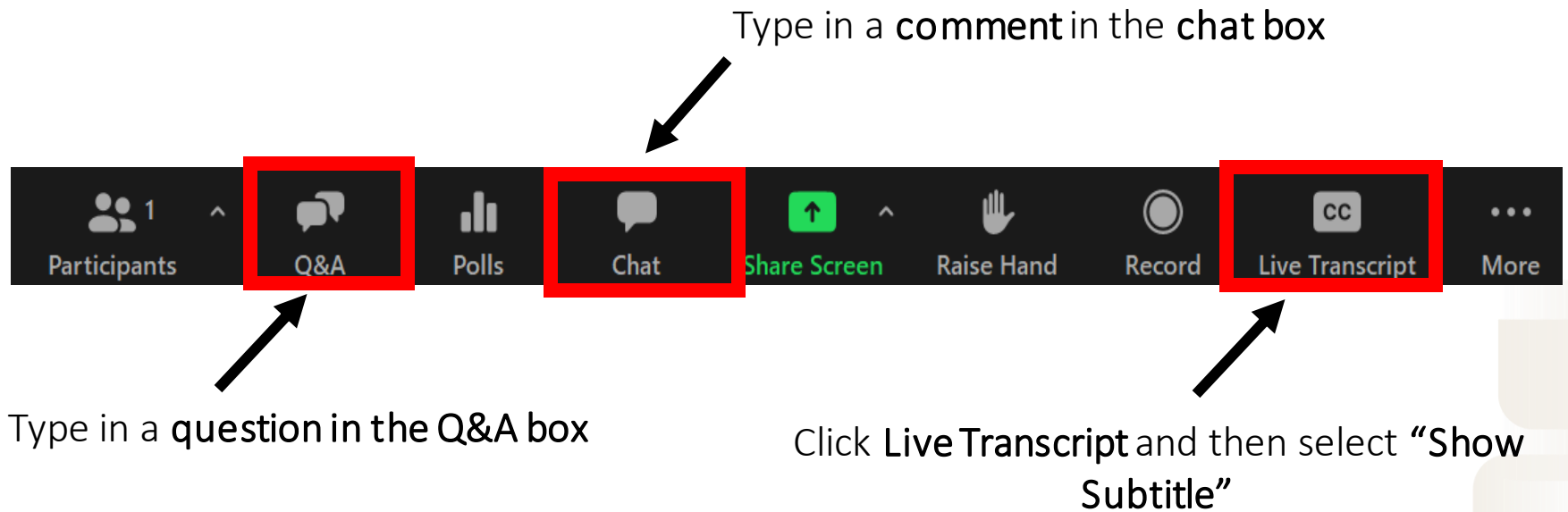

# Disclaimer

The views, opinions, and content expressed in this presentation do not necessarily reflect the views, opinions, or policies of the Center for Mental Health Services (CMHS), the Substance Abuse and Mental Health Services Administration (SAMHSA), or the U.S. Department of Health and Human Services (HHS).

***SAMHSA***

Substance Abuse and Mental Health  
Services Administration

[www.samhsa.gov](http://www.samhsa.gov)

NATIONAL  
COUNCIL  
for Mental  
Wellbeing

# Introductions

## Moderator

- **Sarah Neil**, *Director*, National Council for Mental Wellbeing

## Panelists

- **Riah Patterson, MD**, *Assistant Professor, Medical Director*, Perinatal Psychiatry In-Patient Unit, University of North Carolina (UNC) Hospitals- Chapel Hill
- **Margo Nathan, MD**, *Assistant Professor*, University of North Carolina (UNC) Hospitals- Chapel Hill
- **Dr. Maria Manriquez**, *Professor, Director ObGyn and Addiction Medicine Specialist*, University of Arizona College of Medicine Phoenix, Clinical care at Banner University Medical Center Phoenix
- **Tara Sundem**, *Hushabye Nursery Founder and Executive Director*, Hushabye Nursery

NATIONAL  
COUNCIL  
*for Mental  
Wellbeing*



# Strategies to Leverage Perinatal Health Equity

---

**Studies indicate that understanding trends in opiate and substance use during pregnancy and related challenges plays a pivotal role in being able to provide the needed continuum of care for families and individuals.**

From supporting families experiencing substance use disorders, serious mental illness, and other health and social needs, speakers throughout the series shared how integrated care can address the unique needs of pregnant and post-partum people through innovative partnerships, de-stigmatizing and supportive environments, and person-centered care.

NATIONAL  
COUNCIL  
*for Mental  
Wellbeing*



# Tools & Resources (1 of 3)

- [Center of Excellence for Integrated Health Solutions](#)
  - **Perinatal Health Part 1:** The Case for Integration & Considerations Across the Continuum of Care – [slides & recording](#)
  - **Perinatal Health Part 2:** Perinatal Behavioral Health Care in a Certified Behavioral Health Center (CCBHC) – [slides & recording](#)
  - **Perinatal Health Part 3:** Integrating Services for Pregnant and Postpartum People in High Need Setting – [slides & recording](#)
  - **Perinatal Health Part 4:** Addressing Serious Mental Illness – [slides & recording](#)
- [National Council for Mental Wellbeing – Mental Health First Aid](#)
- [HHS – New Maternal Mental Health Hotline](#)
- [Care Plus NJ](#)
- [Denver Health](#)
- [Moms Do Care](#)
- **Centers for Medicare and Medicaid Services** – [Improving Maternal Health and Extending Postpartum Coverage in Medicaid and the Children’s Health Insurance Program \(CHIP\)](#)
- [Integrating Substance Use Disorder and OB/GYN Care Brief](#)

# Tools & Resources (2 of 3)

- [Maternal, Infant, and Child Health – Healthy People 2020](#)
- [Perinatal Mental Health Alliance for People of color](#)
- **HRSA Maternal & Child Health** - [Maternal and Child Health Bureau](#)
- [HRSA: Screening & Treatment for Maternal Depression & Related Behavioral Disorders Program \(MDRDB\)](#)
- [California Maternal Quality Care Collaborative \(CMQCC\) - Toolkits](#)
- [Fetal Alcohol Spectrum Disorders Research Briefs](#)
- [Alliance for Innovation on Maternal Health](#)
- [American Academy of Pediatrics](#)
- [American Hospital Association – Better Health for Mothers and Babies](#)
- [American Hospital Association – Supporting Black Women's Maternal Mental Health Journey](#)
- [Women's Health Journal Article: Improving Latinas' Perinatal Mental Health During COVID-19 Crisis](#)
- [Perinatal Depression: Preventive Interventions](#)
- [WNY Postpartum Connection Inc: Directory of Mental Health and Support Services for Pregnant and Post Partum People of Color](#)
- [California Community Prisoner Mother Program](#)

NATIONAL  
COUNCIL  
*for* Mental  
Wellbeing



# Tools & Resources (3 of 3)

- [Hushabye Nursery](#)
- [National Center on Substance Abuse & Child Welfare](#)
- [Opioid Use Disorder & Pregnancy](#)
- [24 hour MAT](#)
- [NAS/ NOWS & Navigating the system](#)
- [Improving Maternal Health and Extending Postpartum Coverage in Medicaid and the Children's Health Insurance Program \(CHIP\)](#)
- [Fetal Alcohol Spectrum Disorders Research Briefs](#)
- [Integrating Substance Use Disorder and OB/GYN Care Brief](#)
- [Maternal, Infant, and Child Health – Healthy People 2020](#)
- [Perinatal Mental Health Alliance for People of color](#)
- [Perinatal Depression: Preventive Interventions](#)
- [WNY Postpartum Connection Inc: Directory of Mental Health and Support Services for Pregnant and Post Partum People of Color](#)
- [NHSA-AIM CCI Racial Equity Learning Series](#)
- [INSPIRE Method Training – Maternal Mental Health](#)
- [National Birth Equity Collaborative - Respectful Maternity Care](#)





# Upcoming CoE Events:

CoE-IHS Office Hour: Integrated Care Strategies to Reduce Barriers to Substance Use Treatment among Communities of Color

[Register for the Office Hour](#) on Tuesday, September 13th, 2-3pm ET

CoE-IHS Webinar: Culturally and Linguistically Appropriate Services Part 1 - History and Purpose of the CLAS Standards

[Register for the Webinar](#) on Tuesday, September 20th, 2-3pm ET

Interested in an individual consultation with the CoE experts on integrated care?  
[Contact us through this form here!](#)

Looking for free trainings and credits?

[Check out integrated health trainings from Relias here](#)

Subscribe for Center of Excellence Updates

[Subscribe here](#)

NATIONAL  
COUNCIL  
for Mental  
Wellbeing

# Thank You

## Questions?

Email [integration@thenationalcouncil.org](mailto:integration@thenationalcouncil.org)

SAMHSA's Mission is to reduce the impact of substance abuse and mental illness on America's communities.

[www.samhsa.gov](http://www.samhsa.gov)

1-877-SAMHSA-7 (1-877-726-4727) 1-800-487-4889 (TDD)

NATIONAL  
COUNCIL  
for Mental  
Wellbeing