



NATIONAL
COUNCIL
for Mental
Wellbeing

CoE-IHS Office Hour: Improving Equity in Integrated Care Services Among Latinx Migrant Communities

Thursday, December 15th, 2022
12-1pm ET

CENTER OF EXCELLENCE for Integrated Health Solutions

Funded by Substance Abuse and Mental Health Services Administration and operated by the National Council for Mental Wellbeing

Questions, Comments & Closed Captioning

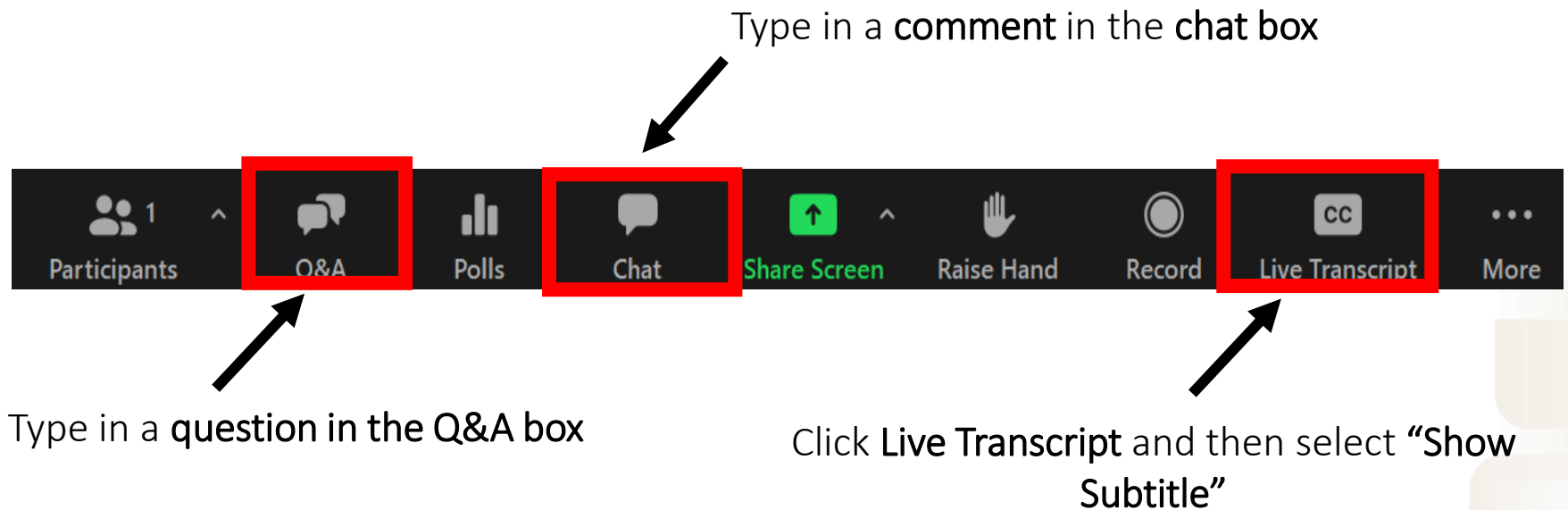

NATIONAL
COUNCIL
for Mental
Wellbeing

Disclaimer

The views, opinions, and content expressed in this presentation do not necessarily reflect the views, opinions, or policies of the Center for Mental Health Services (CMHS), the Substance Abuse and Mental Health Services Administration (SAMHSA), or the U.S. Department of Health and Human Services (HHS).

SAMHSA

Substance Abuse and Mental Health
Services Administration

www.samhsa.gov

NATIONAL
COUNCIL
for Mental
Wellbeing

Introductions

Moderator

- **Paula Zaremba**, *MHS, Project Manager*, Practice Improvement & Consulting, National Council for Mental Wellbeing

Panelists

- **Ana Carina Ordaz**, *PhD Candidate*, University of Georgia
- **Lukas Soto (Ojibwe/Mapuche)**, *Founder & Owner*, Lukas M. Soto Consulting

Health Equity Faculty Panelists

- **Dr. Pierluigi Mancini**, *President*, Multicultural Development Institute
- **Dr. Terence Fitzgerald**, *Consultant*, Practice Improvement & Consulting, National Council for Mental Wellbeing
- **Dr. Ami Roeschlien**, *Consultant*, Practice Improvement & Consulting, National Council for Mental Wellbeing
- **Aaron Williams**, *Senior Advisor*, Practice Improvement & Consulting, National Council for Mental Wellbeing



NATIONAL
COUNCIL
*for Mental
Wellbeing*

Health Equity Tools & Resources

- [Center of Excellence for Integrated Health Solutions](#)
- [Access for Everyone: A Toolkit for Addressing Health Equity & Racial Justice within Integrated Care Settings](#)
- [Social Justice Leadership Academy \(SJLA\) Workbook](#)
- [Racial Equity Tools](#)
- [Diversity, Equity & Inclusion Framework](#)
- [Racial Equity Toolkit](#)
- [Raising the Bar \(RtB\) Framework](#)



[Health Equity and Racial Justice Webpage](#)

National Council for Mental Wellbeing

See our page for more information on Webinars and Upcoming Events, Resources and Tools, and Training and Technical Assistance focused on Health Equity and Racial Justice

NATIONAL
COUNCIL
for Mental
Wellbeing

Additional Resources (1 of 2)

For Providers:

- [Hispanic and Latino TTC - eCompendium of Evidence-Based programs](#)
- [MHA Supporting Mental Health of Immigrant Communities Presentation](#)
- [Guide to Providing Mental Health Services to Immigrants Impacted by Changes to Deferred Action for Childhood Arrivals \(DACA\) and the COVID—19 Pandemic](#)
- [Immigration Enforcement and Mental Health of Latino High School Students](#)
- [LatinX Therapy Podcast](#)
- [Migrant Clinicians Network](#)
- [Call for Submissions: New Profit's Mental Health Equity Catalyze Cohort](#) - funding opportunity

Client Resources:

- [Todo Por Mi Familia](#) - free, confidential mental health services to families who were forcibly separated at the US border.
- [Hola! Crisis Text Line in Spanish](#)
- [Farm Aid Hotline for farmers and farmworkers \(Spanish hotline available\)](#)
- [Supporting Transgender Immigrant & Refugee Youth \(STIRY\) - Resource List](#)

NATIONAL
COUNCIL
for Mental
Wellbeing

Additional Resources (2 of 2)

- **In Spanish:**
 - [Mental Health First Aid \(now available in Spanish\)](#)
 - [Recursos en Español – Informacion y Materials de Salud Mental en Español](#)
 - [Compartiendo Esperanza: No Hay Salud Sin Salud Emocional](#)
 - [MHA Latinx/Hispanic Communities and Mental Health](#)
- **Other Language resources:**
 - [Behavioral Health Interpreter Training \(BHTI\)](#)
 - [National Council on Interpreting in Health Care](#)
- **SAMHSA Resources**
 - Addiction - [Hispanic and Latino Addiction Technology Transfer Center Network](#)
 - Prevention - [Hispanic and Latino Prevention Technology Transfer Center](#)
 - Mental Health – [Hispanic and Latino Mental Health Technology Transfer Center](#)
- **General**
 - [Supporting Health Equity and Affordable Health Coverage for Immigrant Populations](#)
 - [Immigration, Health Care and Health research & articles](#)
 - [Being Non-Binary in a Language Without Gendered Pronouns](#)

NATIONAL
COUNCIL
for Mental
Wellbeing

Previous Health Equity Office Hour Sessions



- [Resources to Advance Health Equity through Integrated Health](#) (Jan. 2022)
- [Understanding Black & African American Experiences in Mental Health & Substance Use Services](#) (Feb. 2022)
- [Breaking Down Health Literacy, Cultural and Linguistic Barriers in Integrated Care Settings](#) (Mar. 2022)
- [Racial Equity & Social Justice in Integrated Care Settings](#) (Apr. 2022)
- [Health Equity in Perinatal Health](#) (May 2022)
- [Providing Affirming & Supportive Care to Transgender Individuals in Integrated Care Settings](#) (Jun. 2022)
- [Providing Integrated Care Services & Advancing Health Equity for Individuals with Intellectual and Development Disabilities](#) (Aug. 2022)
- [Integrated Care Strategies to Reduce Barriers to Substance Use Treatment Among Communities of Color](#) (Sept. 2022)
- [Culturally and Linguistically Appropriate Services \(CLAS\) Standards](#) (Nov. 2022)

Upcoming CoE Events:

CoE-IHS Webinar: Population Health Part 2- Measurement-Informed Care

[Register for the webinar](#) on January 12th, 2-3pm ET

CoE-IHS Webinar: Population Health Part 3- Clinical Pathways

[Register for the webinar](#) on February 7th, 2-3pm ET

Interested in an individual consultation with the CoE experts on integrated care?

[Contact us through this form here!](#)

Looking for free trainings and credits?

[Check out integrated health trainings from Relias here](#)

Subscribe for Center of Excellence Updates

[Subscribe here](#)

NATIONAL
COUNCIL
for Mental
Wellbeing

Speaker Bios

Ana Carina Ordaz

Carina Ordaz is a bicultural and bilingual practicing Latina therapist. She earned her Master's Degree in clinical mental health counseling from Georgia State University and is currently working on her Ph.D. in counseling psychology at the University of Georgia. She is in her second appointment year with the American Psychological Association (APA) Minority Fellowship Program in Mental Health and Substance Abuse Services, funded by a grant from the federal Substance Abuse and Mental Health Services Administration (SAMHSA). Through her training, she has gained clinical experience in counseling centers, community mental health and hospital settings. She is also trained in bilingual play therapy, which creates spaces of healing and coping for children and families. As advocacy representative for the Georgia Psychological Association Graduate Student Committee (GPAGS), she has the opportunity to engage in advocacy efforts to center the needs of undergraduate and graduate psychology students. Her research interests focus on understanding complex trauma and post-traumatic growth within immigrant communities, specifically, the pre-, in-transit and post-immigration narratives of individuals and families in Georgia. Her lived identities and leadership roles have informed her work and she has seen first-hand the need to address social and racial injustices within mental health and recovery services. She continues to address and engage in critical dialogue around the need for culturally and linguistically competent mental health and substance use treatment services. Overall, she is dedicated to serving underrepresented and marginalized communities, and through her work, she hopes to fight the stigma around mental illness one day at a time.

Lukas Soto

Lukas Soto (Ojibwe/Mapuche) is a two-spirit community organizer, abolitionist, storyteller, and death doula. They bring nearly ten years of experience in community organizing, empowerment, healing, and justice. Their work utilizes an interdisciplinary and intersectional approach to racial and social justice work including advocacy and previous consulting experience in healthcare, higher education, nonprofits, and government. They live on the Pyramid Lake Reservation with their teacher Dean Barlese learning traditional death work, ecological knowledge, and craftwork.

Dr. Pierluigi Mancini

One of the most sought after national and international consultants and speakers on mental health and substance use treatment, Dr. Mancini's areas of expertise are cultural and linguistic competence, immigrant mental health and substance use treatment, social and racial justice, health equity and health disparities. He founded Georgia's only Latino mental health and substance use treatment program in 1999 and has provided expert content to clients in the United States, Mexico, Italy, Colombia, Cuba and Kosovo. He led a project to train clinicians in Latin America for the 4 million displaced Venezuelans in the region. His work has won a combined six EMMY awards and has been named one of the 50 Most Influential Latinos in Georgia; honored with the NLPA Star Vega; the UnidosUS Helen Rodríguez-Trías; and the Mental Health America "Heroes in the Fight" Awards. He serves on the Mental Health America (MHA) Board and the boards of Wellstar Atlanta Medical Center and R.I. International.

NATIONAL
COUNCIL
for Mental
Wellbeing

Speaker Bios (cont'd)

Aaron Williams

Aaron Williams has more than 18 years of experience providing training and technical assistance in mental health and substance use services with an emphasis on substance use treatment and prevention, workforce development and implementation of evidence-based-practices in clinical settings.

Williams has written and contributed to numerous articles and reports on drug misuse; primary care and substance use integration; Screening, Brief Intervention and Referral to Treatment (SBIRT); mental health and primary care integration; workforce development of mental health and substance use providers; and implementation of medication-assisted treatment (MAT) services.

Williams holds a bachelor's degree in psychology from Morehouse College and a master's degree in psychology from The Catholic University of America. He is currently a member of the American Psychological Association's Society of Addiction Psychology and the Association for Multidisciplinary Education and Research in Substance use and Addiction.

Focus Areas: Integration of Primary Care and Substance Use Services, Implementation of Medications for addiction treatment, Recovery-Oriented Systems of Care, Substance Use and Health Equity, SBIRT.

Dr. Ami Roeschlein

Amelia ("Ami") Roeschlein, DSW, MA, LMFT, is a skilled licensed clinician who has led health care teams in mental health and substance use services programs for 20 years. She is currently faculty at the University of Southern California and excels at developing and implementing programs in health care settings. Dr. Roeschlein has published research and spoken at numerous state, national and international conferences on interpersonal violence, co-occurring disorders, trauma-informed care, compassion cultivation, and leadership and team-based health care. She is a member of the British Psychoanalytic Council's list of qualified Mentalization Based Treatment Practitioners and active in the American Association of Marriage and Family Therapists, American Academy of Social Work and Social Welfare, and the American Interprofessional Health Collaborative. She completed her doctorate at the University of Southern California with a focus on innovation and creating large-scale social change through transdisciplinary training of mental health practitioners.

Dr. Terence Fitzgerald

Terence Fitzgerald is a former clinical associate professor of social work. Fitzgerald grew up in Champaign, Illinois, where he graduated from the University of Illinois at Urbana-Champaign and earned a bachelor's degree in liberal arts, a master's degree in both school social work and educational leadership, and a doctorate in education policy studies. As both a social worker and race scholar, for 12 years, Fitzgerald worked through K-12th grade levels as a school social worker, and then later as a special education equity coordinator in racially and economically diverse settings in Central Illinois. He has worked with social justice grassroots organizations that focus on marginalized children and families, aligned for the purpose of meeting state and federal requirements, and helped organizations and corporations work toward meeting the needs of culturally and socially just environments. Professionally, he has utilized his program and curriculum evaluation talents to enable public schools in Illinois to make financial, efficient, ethical, racially, and just program and curriculum changes. His work regarding his expertise as a racial scholar is spotlighted in numerous international and national media outlets, peer-reviewed journals, and collaborative and independent published books. For example, *The Reality of Diversity, Gender, and Skin Color: From Living Room to Classroom, White Prescriptions?: The Dangerous Social Potential for Ritalin and other Psychotropic Drugs to Harm Black Males, Black Males and Racism: Improving the Schooling and Life Chances of African Americans.*"

NATIONAL
COUNCIL
for Mental
Wellbeing

Thank You

Questions?

Email integration@thenationalcouncil.org

SAMHSA's Mission is to reduce the impact of substance abuse and mental illness on America's communities.

www.samhsa.gov

1-877-SAMHSA-7 (1-877-726-4727) 1-800-487-4889 (TDD)

NATIONAL
COUNCIL
for Mental
Wellbeing