

CoE-IHS Office Hour:  
Suicide Prevention and Post-Partum  
Depression among Black & African  
American Women

Wednesday, April 12th, 2023  
1-2pm ET

**CENTER OF EXCELLENCE** for Integrated Health Solutions

Funded by Substance Abuse and Mental Health Services Administration and operated by the National Council for Mental Wellbeing

# Questions, Comments & Closed Captioning

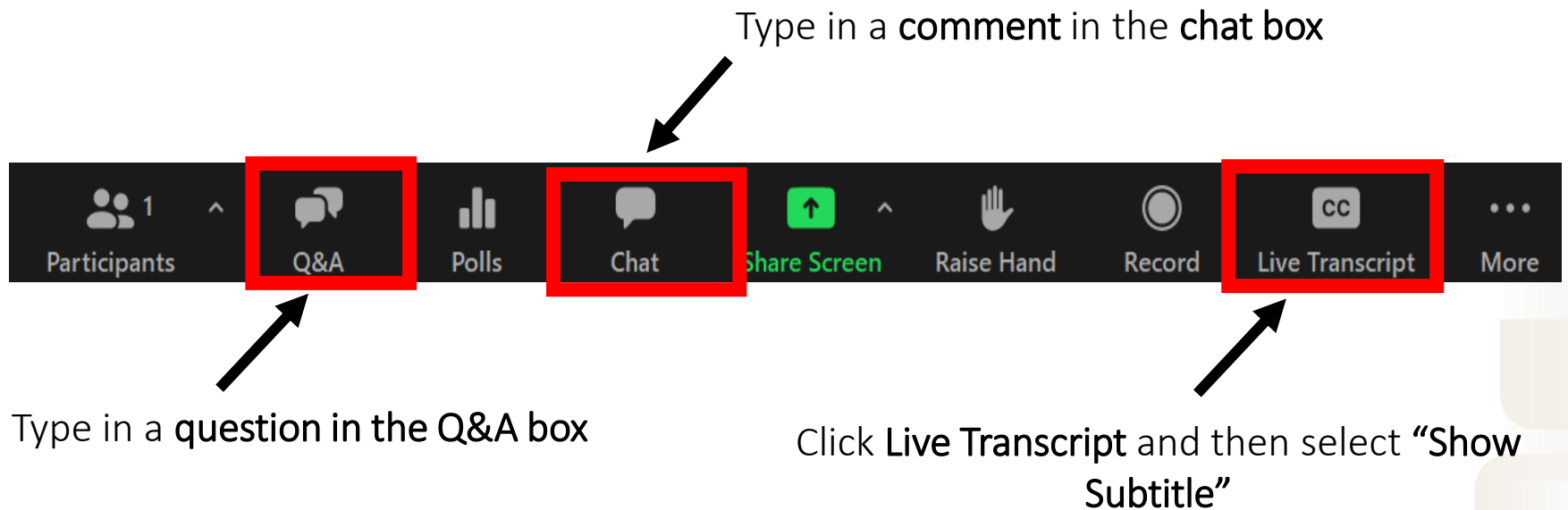

# Disclaimer

The views, opinions, and content expressed in this presentation do not necessarily reflect the views, opinions, or policies of the Center for Mental Health Services (CMHS), the Substance Abuse and Mental Health Services Administration (SAMHSA), or the U.S. Department of Health and Human Services (HHS).

***SAMHSA***

Substance Abuse and Mental Health  
Services Administration

[www.samhsa.gov](http://www.samhsa.gov)

NATIONAL  
COUNCIL  
for Mental  
Wellbeing

# Introductions

## Moderator

- **Dr. Ami Roeschlein**, *Consultant*, Trauma-Informed, Resilience-Oriented Services, Center of Excellence for Integrated Health Solutions, National Council for Mental Wellbeing

## Panelists

- **Aaron Williams**, *Senior Advisor*, Practice Improvement & Consulting, National Council for Mental Wellbeing
- **Dr. Terence Fitzgerald**, *Consultant*, Trauma-Informed, Resilience-Oriented Services, Center of Excellence for Integrated Health Solutions, National Council for Mental Wellbeing
- **Linda Henderson-Smith**, *PhD, LPC, CPCS*, President and CEO of ATC Consulting, LLC.

NATIONAL  
COUNCIL  
*for Mental  
Wellbeing*

The U.S. has the highest maternal mortality rate among developed nations. And, while post-partum depression (PPD) affects 1 in 8 women in the U.S., women of color, particularly Black and African American women, consistently experience the greatest risk, but are less likely to receive access to equitable care due to challenges such as financial barriers, prejudice toward those experiencing mental health and substance use challenges, and a historical distrust of the health care system.

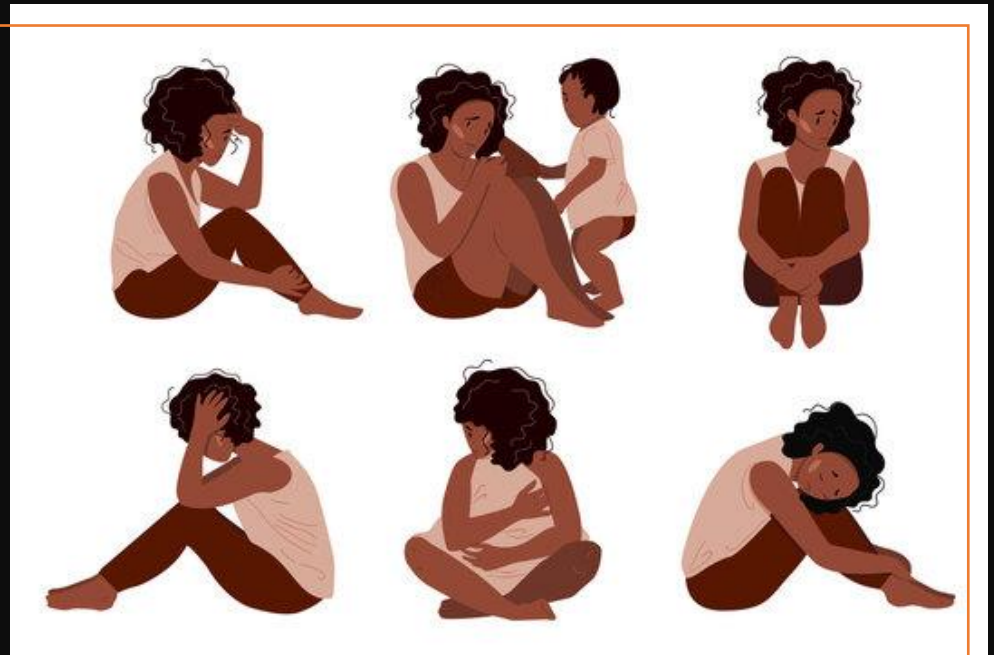

# Tools & Resources

## National Council for Mental Wellbeing

- [Access for Everyone: A Toolkit for Addressing Health Equity & Racial Justice within Integrated Care Settings](#)
- [Suicide Prevention and Management](#)
- [Mental Health First Aid](#)
- [Diversity, Equity & Inclusion Framework](#)
- [Racial Equity Toolkit](#)
- [Suicide Prevention Awareness Month](#)



## Blog Posts

- [Supporting Black Women's Maternal Mental Health Journey](#)
- [Racial and Ethnic Disparities in Postpartum Depression Care Among Low-Income Women](#)
- [Furthering the Wellbeing of Black, Indigenous & People of Color through Integrated Care](#)
- [During Black History Month, Let's Commit Ourselves to Improving the Mental Health of Black Americans](#)
- [Moving Forward this Black History Month – Setting Youth Up for Success](#)

NATIONAL  
COUNCIL  
for Mental  
Wellbeing

# Tools & Resources (2 of 3)

## Black-led Mental Wellness Advocacy Organizations to Support

- [Black Emotional and Mental Health Collective](#)

## [African American Behavioral Health CoE:](#)

- [AA BH CoE Resource Page](#)
- [Suicide in U.S. Black and African American Communities](#)
- [Addressing Disparities in Access & Utilization of SU & MH Services Among Blacks & African Americans](#)

### [Health Equity and Racial Justice Webpage](#)

*National Council for Mental Wellbeing*

*See our page for more information on Webinars and Upcoming Events, Resources and Tools, and Training and Technical Assistance focused on Health Equity and Racial Justice*

NATIONAL  
COUNCIL  
for Mental  
Wellbeing

# Tools & Resources

## (3 of 3)

### Other Resources:

- [Black Mental Health Alliance](#)
- [Women's Depression Symptoms May Differ by Race: Study \(usnews.com\)](#)
- [5 Reasons Suicide Is on the Rise in Black Communities | Everyday Health](#)
- [The Crisis Killing Black Women | The Nation](#)
- [I Don't Wanna Be: Suicide Rates Are Rising Among Young Black Men \(sacobserver.com\)](#)
- [What Everyone Gets Wrong About Suicide: An Open Letter From A Survivor \(essence.com\)](#)





# Upcoming CoE Events:

CoE-IHS Webinar: Part 1: Leveraging Telehealth to Improve Access & Reach in Rural Integrated Care

[Register for the webinar](#) on Thursday, April 20th, 2-3pm ET

CoE-IHS Office Hour: Determining Level of Care within Crisis Services

[Register for the office hour](#) on Thursday, April 27th, 2-3pm ET

Interested in an individual consultation with the CoE experts on integrated care?  
[Contact us through this form here!](#)

Looking for free trainings and credits?  
[Check out integrated health trainings from Relias here](#)

Subscribe for Center of Excellence Updates  
[Subscribe here](#)

NATIONAL  
COUNCIL  
for Mental  
Wellbeing

# Thank You

## Questions?

Email [integration@thenationalcouncil.org](mailto:integration@thenationalcouncil.org)

SAMHSA's Mission is to reduce the impact of substance abuse and mental illness on America's communities.

[www.samhsa.gov](http://www.samhsa.gov)

1-877-SAMHSA-7 (1-877-726-4727) 1-800-487-4889 (TDD)

NATIONAL  
COUNCIL  
for Mental  
Wellbeing