

CoE-IHS Office Hour: One Year Later- Workforce Accomplishments & Lessons Learned

Wednesday, April 26, 2023

12-1pm ET

Questions, Comments & Closed Captioning

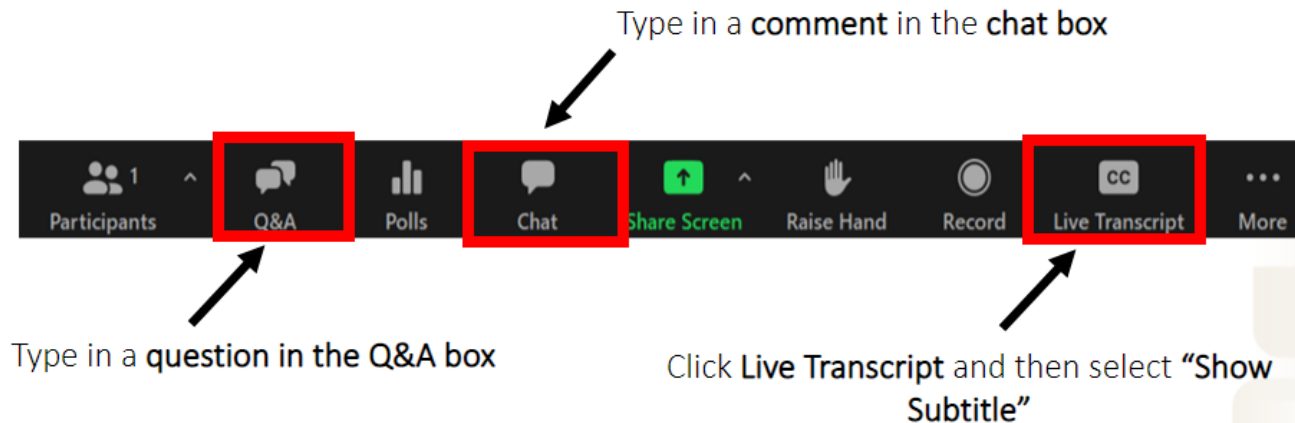

Disclaimer

The views, opinions, and content expressed in this presentation do not necessarily reflect the views, opinions, or policies of the Center for Mental Health Services (CMHS), the Substance Abuse and Mental Health Services Administration (SAMHSA), or the U.S. Department of Health and Human Services (HHS).



NATIONAL
COUNCIL
for Mental
Wellbeing

Today's Speakers

Panel Moderator:

- **Ellie Boyarski, LCSW-BCD**, Sr. Advisor & Consultant, National Council for Mental Wellbeing

Panelists:

- **Lakeya Cherry, DSW, MSSW, ACC** *Chief Executive Officer & Executive Coach*, Lakeya Cherry LLC. & *Consultant*, National Council for Mental Wellbeing
- **Tamanna Patel, MPH, CDP**, Director, Practice Improvement & Consulting, National Council for Mental Wellbeing
- **Janeen Haller-Abernathy, LCSW**, Director, Colorado State Employee Assistance Program (CSEAP)
- **Jennifer Bender, RN-C, IBCLC**, Perinatal Nurse Navigator, Mon Health Women's Services

NATIONAL
COUNCIL
for Mental
Wellbeing



Successful Innovations in Workforce Retention (HR)

Rural, agricultural and tribal communities face a particular set of health inequities that are not as common in urban areas. Several factors including historical injustices, structural urbanism and the effects of the mental health and recovery services workforce shortage have disproportionately impacted access to health services in rural communities.

With the increased demand for mental health and substance use treatment services, but limited capacity in the mental wellbeing workforce in rural areas, providers and organizations in rural communities are getting creative and implementing ideas that leverage the many strengths of rural communities to improve their workforce related needs.

Telehealth Rural Webinar Series

First Session Recording:

- [Part 1: Leveraging Telehealth to Improve Access & Reach in Rural Integrated Care](#)

Register for Upcoming Sessions below:

- Tuesday, May 16th - [Part 2: Rural Telehealth & M-Health for Children & Youth](#)
- Thursday, June 22nd - [Part 3: Rural Telehealth & M-Health for Immigrants and Migrants](#)





NATCON23
MAY 1-3, 2023

*Last chance to sign up for a **FREE 30 minute Discussion Den at NatCon23!** Come meet with our CoE-IHS Integrated Health experts like Alicia Kirley, Aaron Williams, Dr. Terence Fitzgerald, Pam Pietruszweski, Joan King, Laura Leone and others!*

Don't miss your opportunity to experience a [one-on-one, 30-minute consultation](#) with National Council subject matter experts from May 1-3 at the Los Angeles Convention Center.

Reserve Your Seat

Choose from the following topics:

- Integrated health
- Recruitment and retention efforts (with Triad)
- Individualized risk management (with MHHRG Negley)
- Measurement-based care
- Motivational interviewing
- Developing cultural competence and humility
- Diversity, equity, inclusion and belonging (DEIB)
- ...and more!



NATIONAL
COUNCIL
for Mental
Wellbeing

Tools & Resources

- National Council for Mental Wellbeing- [Rural Interest Group](#)
- [Workforce Innovations in Integrated Care](#)
- [Integrated Approaches to Improving Rural Health Equity and Access](#)
- [Rural Health Information Hub](#)
- [American Communities Project](#)
- [Telehealth Services: Rural Health Fact Sheet Series](#)
- [Workforce Capacity for Reducing Rural Disparities in Public Mental Health Services for Adults with Severe Mental Illness](#)
- [Turning COVID-19 Challenges into Opportunities: Tele-Behavioral Health within Latino Communities](#)
- [New Study: Behavioral Health Workforce Shortage Will Negatively Impact Society](#)

NATIONAL
COUNCIL
for Mental
Wellbeing

Previous Sessions

- [Rural Health Part 1: Addressing Structural Urbanism in Rural Communities through Integrated Care](#)
- [Rural Health Part 2: Strategies for Recruiting and Retaining a Strong Rural Health Workforce](#)
- [CoE Office Hour: Resources & Tools for Advancing Rural Health Equity through Integrated Care](#)
- [CoE Office Hour: Rural Health Challenges During COVID-19](#)

NATIONAL
COUNCIL
*for Mental
Wellbeing*

Upcoming CoE Events

CoE-IHS Webinar: Part 2: Rural Telehealth & M-Health for Children & Youth

[Register for the Webinar](#) on Tuesday, May 16th from 2-3pm ET

CoE-IHS Office Hour: May Health Equity Office hour

[Register for the Office Hour](#) on Tuesday, May 23rd from 2-3pm ET

Interested in an individual consultation with the CoE experts on integrated care?

[Contact us through this form here!](#)

Looking for free trainings and credits?

[Check out integrated health trainings from Relias here](#)

Subscribe for Center of Excellence Updates

[Subscribe here](#)

NATIONAL
COUNCIL
for Mental
Wellbeing

Thank You

Questions?

Email integration@thenationalcouncil.org

SAMHSA's Mission is to reduce the impact of substance abuse and mental illness on America's communities.

www.samhsa.gov

1-877-SAMHSA-7 (1-877-726-4727) 1-800-487-4889
(TDD)

NATIONAL
COUNCIL
for Mental
Wellbeing