



NATIONAL  
COUNCIL  
*for* Mental  
Wellbeing

# Integrated Care & Addressing the Needs of Black & African American LGBTQI+ Youth

Tuesday, June 20th, 2023  
2-3pm ET

**CENTER OF EXCELLENCE** for Integrated Health Solutions

Funded by Substance Abuse and Mental Health Services Administration and operated by the National Council for Mental Wellbeing

# Questions, Comments & Closed Captioning

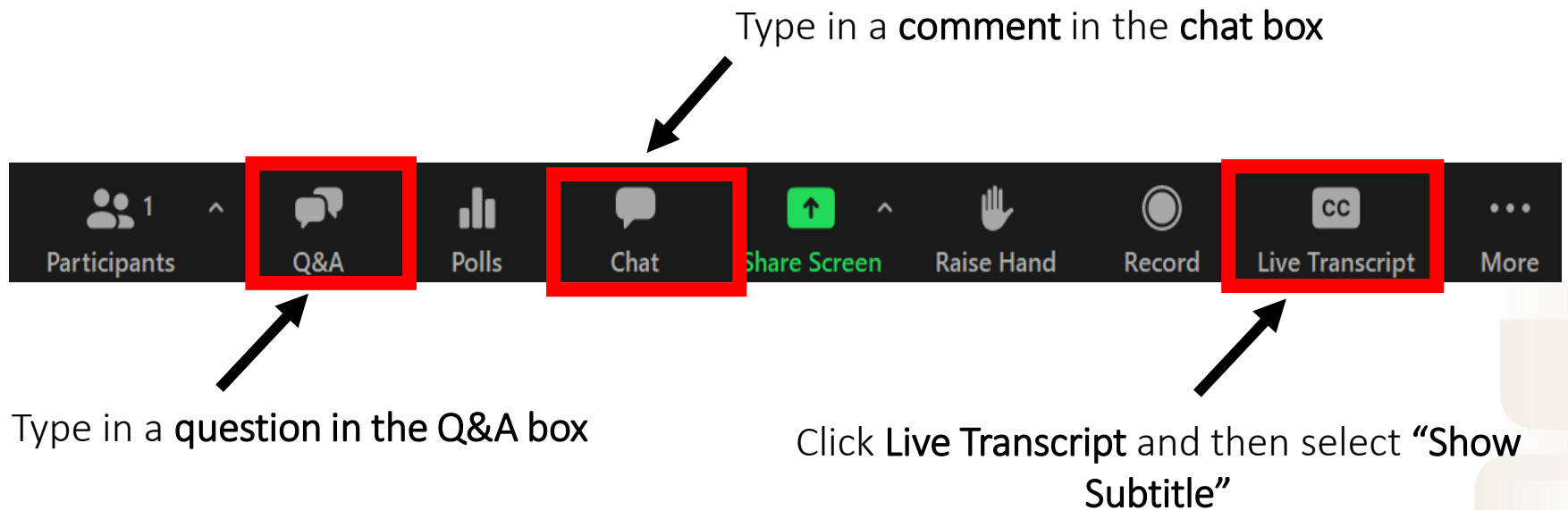

# Disclaimer

The views, opinions, and content expressed in this presentation do not necessarily reflect the views, opinions, or policies of the Center for Mental Health Services (CMHS), the Substance Abuse and Mental Health Services Administration (SAMHSA), or the U.S. Department of Health and Human Services (HHS).

***SAMHSA***

Substance Abuse and Mental Health  
Services Administration

[www.samhsa.gov](http://www.samhsa.gov)

NATIONAL  
COUNCIL  
for Mental  
Wellbeing

# Introductions



**Moderator:**

**Pierluigi Mancini, PhD**

Integrated Health & Health Equity Consultant, National Council for Mental Wellbeing

**Panelists:**



**Skyler Jackson, PhD**

Assistant Professor  
Department of Social and  
Behavioral Sciences  
Yale School of Public Health



**Esette Negussie, LGPC, NCC**

Youth Psychotherapist  
Whitman Walker Health



**Kathleen Sarmiento, DSW,  
LMFT**

CEO, Transformational  
Family Counseling

NATIONAL  
COUNCIL  
for Mental  
Wellbeing



Discrimination and stigma can make it challenging for Black and African American LGBTQ+ youth to access whole person care that supports positive physical and mental health outcomes. Integrated care, which takes a holistic approach to health care, is critical and requires collaborative effort between individuals, their loved ones, health care providers, community leaders and policymakers.

Addressing needs of Black and African American LGBTQ+ youth in integrated care is essential to ensure that all individuals have access to high-quality health care that meets their unique needs.

By providing safe, inclusive and culturally responsive care that is sensitive to the whole person needs of Black and African American LGBTQ+ youth, health care providers can address systemic inequities that negatively impact the health and wellbeing of these communities.

---

NATIONAL  
COUNCIL  
for Mental  
Wellbeing

# Tools & Resources (1/3)

## National Council for Mental Wellbeing

- [Access for Everyone: A Toolkit for Addressing Health Equity & Racial Justice within Integrated Care Settings](#)
- [Suicide Prevention and Management](#)
- [Mental Health First Aid](#)
- [Diversity, Equity & Inclusion Framework](#)
- [Racial Equity Toolkit](#)
- [Suicide Prevention Awareness Month](#)



## Blog Posts

- [Furthering the Wellbeing of Black, Indigenous & People of Color through Integrated Care](#)
- [During Black History Month, Let's Commit Ourselves to Improving the Mental Health of Black Americans](#)
- [Moving Forward this Black History Month – Setting Youth Up for Success](#)

## Black-led Mental Wellness Advocacy Organizations to Support

- [Black Emotional and Mental Health Collective](#)

NATIONAL  
COUNCIL  
for Mental  
Wellbeing

# Tools & Resources (2 of 3)

## Black History Month Resources for Allyship:

- [Addressing Health Equity and Racial Justice](#)
- [Black Students are Still Experiencing Pandemic Trauma](#)

## LGBTQI+ Center of Excellence:

- [Emerging from the Margins: Identifying the Behavioral Health Needs of LGBTQ+ Midlife and Older Adults](#)
- [Center of Excellence LGBTQ+ Behavioral Health Equity E-Learning Modules](#)
- [Supporting Trans Youth](#)
- [Animated Short on Providing Equitable and Affirming Care to LGBTQ+ Older Adults \(6 minutes, 37 seconds\)](#)
- [Webinars on foundational and advanced topics](#)
- [More Resources from the Center of Excellence](#)

**Resource from Skyler Jackson-** <https://lgbtqequity.org/wp-content/uploads/2022/04/Black-LGBTQ-Mental-Health-Infographic.pdf>

### [Health Equity and Racial Justice Webpage](#)

*National Council for Mental Wellbeing*

*See our page for more information on Webinars and Upcoming Events, Resources and Tools, and Training and Technical Assistance focused on Health Equity and Racial Justice*

NATIONAL  
COUNCIL  
for Mental  
Wellbeing

# Tools and Resources (3/3)

## SAMSHA Resources

- [A Provider's Introduction to Substance Abuse Treatment for Lesbian, Gay, Bisexual, and Transgender Individuals](#)
- [A Practitioner's Resource Guide: Helping Families to Support Their LGBT Children](#)
- [Helping Families Support Their Lesbian, Gay, Bisexual, and Transgender \(LGBT\) Children \(PDF | 897 KB\)](#)
- [LGBTQI+ Family Support](#) grant program.



# Upcoming CoE Events

CoE-IHS Webinar: Part 3- Rural Telehealth & M-Health for Immigrants & Migrants

[Register for the webinar](#) on Thursday, June 22nd from 2-3pm ET

CoE-IHS Webinar: Meadowlark: Building a Team-based Approach to Perinatal Care

[Register for the webinar](#) on Wednesday, June 28th from 2-3pm ET

Interested in an individual consultation with the CoE experts on integrated care? [Contact us through this form here!](#)

Looking for free trainings and credits?

[Check out integrated health trainings from Relias here](#)

Subscribe for Center of Excellence Updates

[Subscribe here](#)

NATIONAL  
COUNCIL  
for Mental  
Wellbeing

# Thank You

Questions?

Email [integration@thenationalcouncil.org](mailto:integration@thenationalcouncil.org)

SAMHSA's Mission is to reduce the impact of substance abuse and mental illness on America's communities.

[www.samhsa.gov](http://www.samhsa.gov)

1-877-SAMHSA-7 (1-877-726-4727) 1-800-487-4889 (TDD)

NATIONAL  
COUNCIL  
for Mental  
Wellbeing