

CoE-IHS Office Hour: Meadowlark- Building a Team- Based Approach to Integrated Perinatal care

Thursday, July 27th
1-2 pm ET

CENTER OF EXCELLENCE for Integrated Health Solutions

Funded by Substance Abuse and Mental Health Services Administration and operated by the National Council for Mental Wellbeing

Questions, Comments & Closed Captioning

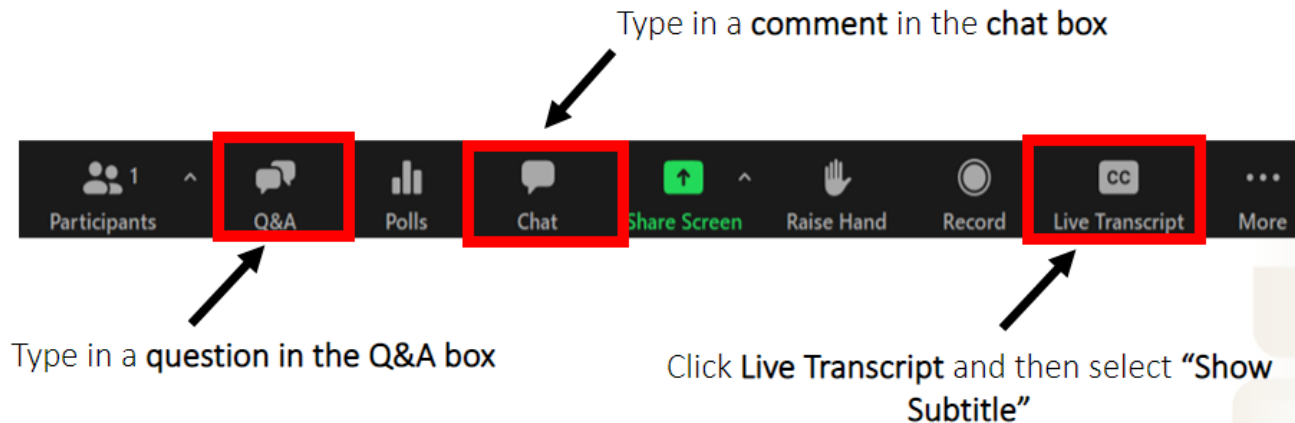

Disclaimer

The views, opinions, and content expressed in this presentation do not necessarily reflect the views, opinions, or policies of the Center for Mental Health Services (CMHS), the Substance Abuse and Mental Health Services Administration (SAMHSA), or the U.S. Department of Health and Human Services (HHS).



NATIONAL
COUNCIL
for Mental
Wellbeing

Today's Speakers

Moderator

- **Joan Kenerson King RN, MSN**, Senior Consultant, The National Council for Mental Wellbeing

Panelist Speakers

- **Tressie White**, Program Director Montana Healthcare Foundation
- **Nicole Grossberg**, Division Administrator for Child and Family Service Division, Montana Department of Public Health and Human Services



NATIONAL
COUNCIL
for Mental
Wellbeing

The Meadowlark Approach



NATIONAL
COUNCIL
for Mental
Wellbeing

The Meadowlark Initiative

Integrating prenatal care and behavioral health to improve maternal and neonatal outcomes

The Meadowlark Initiative brings together clinical and community teams to:

- **PROVIDE** the right care at the right time for women and families.
- **IMPROVE** health outcomes for mothers and babies.
- **KEEP FAMILIES TOGETHER** and children out of foster care.

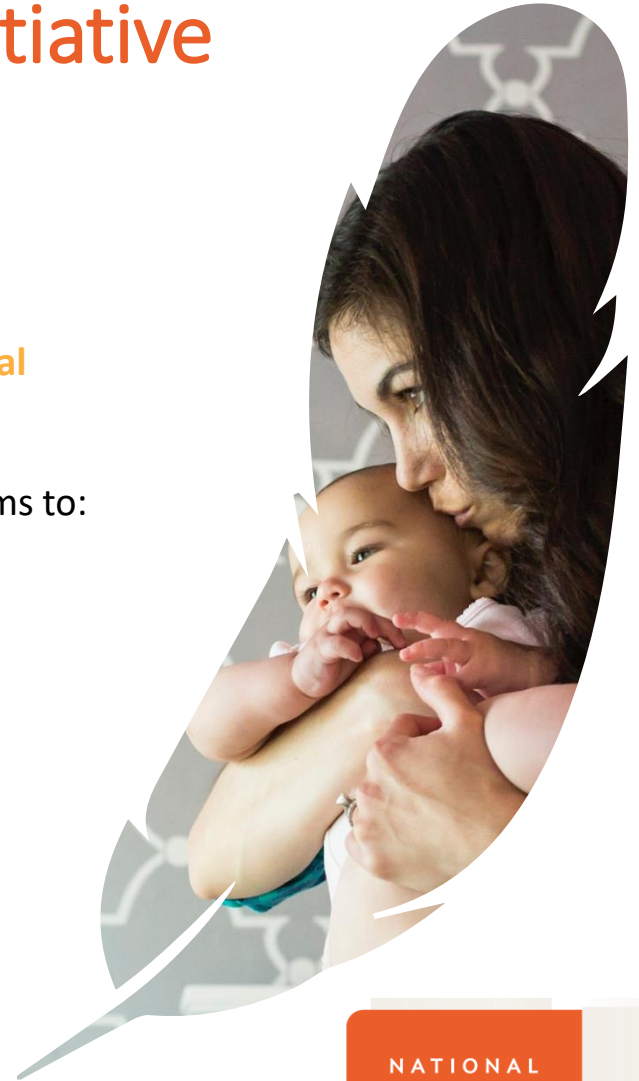

NATIONAL
COUNCIL
for Mental
Wellbeing

Tools & Resources

- [The Meadowlark Initiative](#)
- [Montana Healthcare Foundation](#)
- [Integrating Substance Use Disorder and OB/GYN Care Brief](#)
- [Maternal, Infant, and Child Health – Healthy People 2020](#)
- [Perinatal Mental Health Alliance for People of color](#)
- [Perinatal Depression: Preventive Interventions](#)
- [WNY Postpartum Connection Inc: Directory of Mental Health and Support Services for Pregnant and Post Partum People of Color](#)
- HRSA Maternal & Child Health - [Maternal and Child Health Bureau](#)
- [California Maternal Quality Care Collaborative \(CMQCC\) - Toolkits](#)
- [Alliance for Innovation on Maternal Health](#)
- [American Academy of Pediatrics](#)
- [American Hospital Association – Better Health for Mothers and Babies](#)

NATIONAL
COUNCIL
for Mental
Wellbeing

Previous Related Sessions – Slides & Recordings

[Center of Excellence for Integrated Health Solutions](#)

- Perinatal Health Part 1: The Case for Integration & Considerations Across the Continuum of Care – [slides & recording](#)
- Perinatal Health Part 2: Perinatal Behavioral Health Care in a Certified Behavioral Health Center (CCBHC) - [slides & recording](#)
- Perinatal Health Part 3: Integrating Services for Pregnant and Postpartum People in High Need Settings- [slides & recording](#)
- Perinatal Health Part 4: Addressing Serious Mental Illness- [slides & recording](#)

Check out the Meadowlark Initiative's Webinar session!

- [Wednesday, June 28th - Meadowlark Approach- recording and slides](#)

Upcoming CoE Events

Stay tuned for more upcoming events in August!

Interested in an individual consultation with the CoE experts on integrated care?
[Contact us through this form here!](#)

Looking for free trainings and credits?
[Check out integrated health trainings from Relias here](#)

Subscribe for Center of Excellence Updates
[Subscribe here](#)

NATIONAL
COUNCIL
for Mental
Wellbeing

Thank You

Questions?

Email integration@thenationalcouncil.org

SAMHSA's Mission is to reduce the impact of substance abuse and mental illness on America's communities.

www.samhsa.gov

1-877-SAMHSA-7 (1-877-726-4727) 1-800-487-4889
(TDD)

NATIONAL
COUNCIL
for Mental
Wellbeing