



NATIONAL  
COUNCIL  
*for* Mental  
Wellbeing

# CoE-IHS Equity in Action- Practicing Allyship in Integrated Care

Tuesday, May 14th, 2024  
12-1pm ET

**CENTER OF EXCELLENCE** for Integrated Health Solutions

Funded by Substance Abuse and Mental Health Services Administration and operated by the National Council for Mental Wellbeing

# Questions, Comments & Closed Captioning

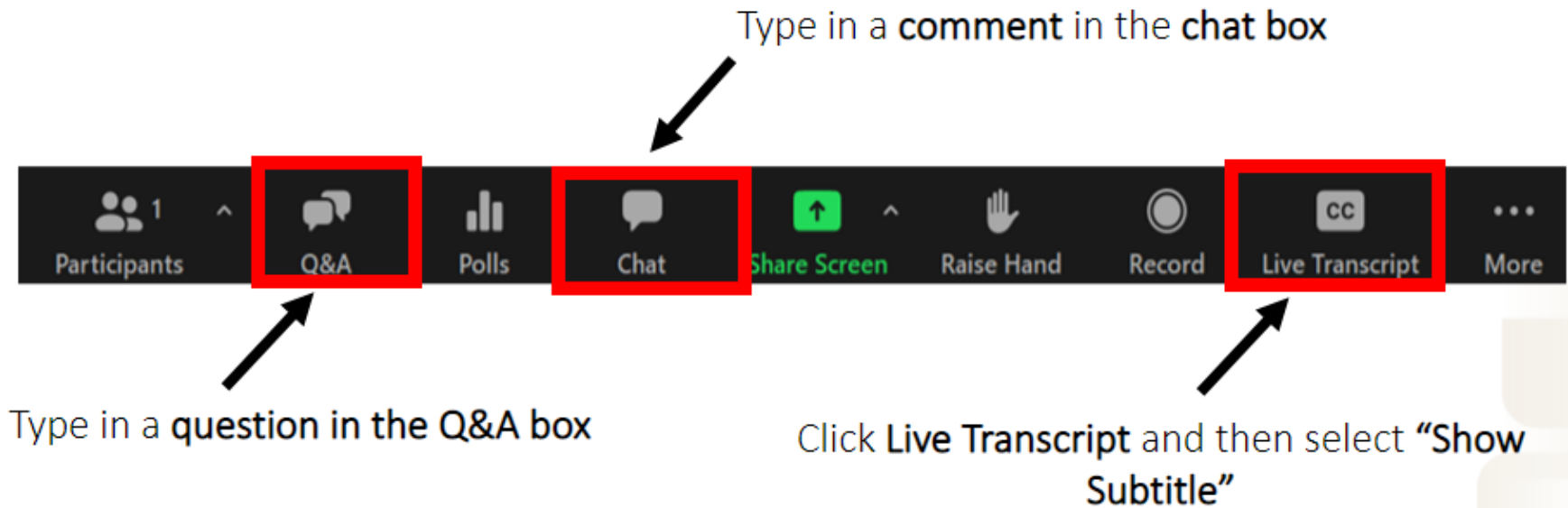

# Disclaimer

The views, opinions, and content expressed in this presentation do not necessarily reflect the views, opinions, or policies of the Center for Mental Health Services (CMHS), the Substance Abuse and Mental Health Services Administration (SAMHSA), or the U.S. Department of Health and Human Services (HHS).

***SAMHSA***

Substance Abuse and Mental Health  
Services Administration

[www.samhsa.gov](http://www.samhsa.gov)

NATIONAL  
COUNCIL  
*for Mental  
Wellbeing*

# Introductions

**Moderator: Dr. Terence Fitzgerald, *Consultant*, Trauma-Informed, Resilience-Oriented Services, Center of Excellence for Integrated Health Solution**

**Guest Panelists:**

- **Dr. Domonique Rice, *Director*, Practice Improvement and Consulting, National Council**
- **Dr. Mari Aceves, EdD, DSW, BCBA, *Consultant*, Trauma-informed, Resilience-oriented, Equity-focused Services, National Council for Mental Wellbeing**

**Health Equity Faculty**

- **Aaron Williams, *Senior Advisor*, Practice Improvement & Consulting, National Council**
- **Dr. Pierluigi Mancini, *President*, Multicultural Development Institute**
- **Dr. Ami Roeschlein, *Consultant*, Practice Improvement & Consulting, National Council**
- **Dr. Lakeya Cherry, *Executive Leadership Coach*, Founder of Lakera Cherry LLC**

NATIONAL  
COUNCIL  
*for Mental  
Wellbeing*

# Practicing Allyship in Integrated Care

---

Championing health equity for historically underserved and marginalized populations often involves speaking up and using one's embedded advantages to practice inclusion and share decision-making and resources when it comes to health care services.

This is especially the case when one doesn't identify with historically marginalized groups, yet has privilege, access to resources, and decision-making ability on a professional level in health care services.

Advancing equity in health care services requires practicing cultural humility—curiosity and willingness to learn, to reflect on one's own cultures and experiences, and to recognize that others have expertise in their own experiences.



# End of Session Poll Questions

See pop up box for **3 poll questions**.

NATIONAL  
COUNCIL  
*for* Mental  
Wellbeing



# Health Equity Tools & Resources

- [Center of Excellence for Integrated Health Solutions](#)
- [Access for Everyone: A Toolkit for Addressing Health Equity & Racial Justice within Integrated Care Settings](#)
- [Social Justice Leadership Academy \(SJLA\) Workbook](#)
- [Racial Equity Tools](#)
- [Diversity, Equity & Inclusion Framework](#)
- [Racial Equity Toolkit](#)
- [Raising the Bar \(RtB\) Framework](#)



## [Health Equity and Racial Justice Webpage](#)

### ***National Council for Mental Wellbeing***

*See our page for more information on Webinars and Upcoming Events, Resources and Tools, and Training and Technical Assistance focused on Health Equity and Racial Justice.*

NATIONAL  
COUNCIL  
for Mental  
Wellbeing

# Integrated Care & Allyship Resources

- [Center of Excellence for Integrated Health Solutions](#)
- [Practical Steps to Understand and Advance Allyship](#) - July 2023 Webinar Recording, National Council
- [Putting Allyship Into Practice](#) - August 2023 Webinar Recording, National Council
- [Use Allyship to Support Communities: Six Ways to Get Started](#) - University of Minnesota Extension
- [Resources on Allyship](#) - George Washington University, Office for Diversity, Equity and Community Engagement
- [Be a Better Ally](#) - Harvard Business Review
- [Anti-Racism Guide: Resources for Education and Action](#) - UC San Diego
- [Allyship and Anti-Oppression: A Resource Guide](#) - Bryn Mawr, Haverford, & Swarthmore Colleges
- [Active Ally Resources](#) - PennState University
- [Black-Led Collective Liberation Resources](#) - Dismantle Collective
- [Allyship Resources](#) - Amnesty International



# Upcoming Events



June  
27

from 11:30am-1pm ET

CoE-IHS  
Webinar: Delivering  
Comprehensive,  
Integrated Care  
for Pregnant and  
Postpartum People

[Register Here](#)

July  
18

from 12-1pm ET

CoE-IHS  
Webinar: BBS  
Billing Modules

[Register Here](#)

Relias On-Demand  
Training

[Learn More](#)

Subscribe for Center of  
Excellence Updates

[Subscribe Here](#)

NATIONAL  
COUNCIL  
for Mental  
Wellbeing

# CHAT WITH AN EXPERT!

*Schedule a free call with an integrated care expert to discuss:*

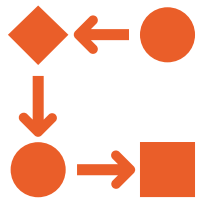

**Implementing  
Models of  
Integrated Care**



**Health Equity  
through  
Integrated Care**



**Population  
Health in  
Integrated Care**



**Workforce  
Development**



**Integrated Care  
Financing &  
Operations**

**Diversity, Equity and Inclusion**

**Ongoing Impacts of COVID-19 Pandemic**

***Submit a Request!***

# Thank You

## Questions?

Email [integration@thenationalcouncil.org](mailto:integration@thenationalcouncil.org)

SAMHSA's Mission is to reduce the impact of substance abuse and mental illness on America's communities.

[www.samhsa.gov](http://www.samhsa.gov)

1-877-SAMHSA-7 (1-877-726-4727) | 1-800-487-4889 (TDD)

NATIONAL  
COUNCIL  
*for* Mental  
Wellbeing